

BODY AND CHASSIS

- Jeep completely torn down to bare frame
- All body panels repaired and welded with new metal as needed.
- Body completely reconditioned and repainted in sections. (Paint work consists of 2 coats of sealer, 5 coats of base paint, 5 coats of urethane. then clear sanding, buffing for a beautiful finish.)
- Undercarriage is seam-sealed, fully undercoated.
- Inside of tub is completely chip-guarded and sealed.
- Chassis is pressure blasted, spray coated and painted with chassis black acrylic enamel paint.
- New full body mount kit installed prior to installation

MOTOR

- Rebuilt 6 cylinder engine (258) with aluminum valve cover
- New or rebuilt (to factory specifications) alternator, carburetor, water pump, fuel pump, distributor, new ignition wires, new solenoid, battery, battery cables, engine mounts, radiator, coolant, hoses, belts.
- Of course - there are many packages available call us or come by and see what is possible.

DRIVE LINE

- Rebuilt 4 speed, 5 speed or automatic transmission
- New clutch (as applicable)
- Rebuilt Dana 20 or 300 transfer case (as applicable)
- Front and rear differentials overhauled with new gear bearings and seals.
- One piece axle replacements in rear with AMC 20
- New or rebuilt (to factory specification) Dana spicer driveshafts front and rear.

SUSPENSION & BRAKES

- 2.5 suspension lift consisting of new springs, shocks, shackles, u-bolts, steering stabilizer
- New or rebuilt (to factory specification) hydraulic components
- New tie-rods and drag links,
- new steering coupler shaft
- Reconditioned steering column with all polyurethane bushings.
- Front brakes - 2 new front rotors, new disc pads new or rebuilt (to factory specification) calipers
- Rear brakes - new brake shoes, 2 new brake drums, 2 new wheel cylinders
- New brake master cylinder
- New (or rebuilt to factory specification) brake booster
- New stainless brake lines

WHEEL & TIRES

- 4 31 X 10.5 X 15 Tires
- 4 15X8 aluminum or chrome wheels
- Standard size space saver tire and spare tire cover

FUEL SYSTEM

- New 15 gallon fuel tank
- New sending unit with new filler and vent hoses
- New fuel lines from tank to motor
- New (or rebuilt to factory specification) brake booster
- New stainless brake lines

INTERIOR & ACCESSORIES

- New soft-top package (Bestop or specialty top)
- New front reclining seats with new slide track on driver's side
- New fold and tumble seat in rear.
- All new seat belts
- Reconditioned (to factory specification) heater assembly with new heater core
- New gauges, switches, cables, and knobs
- New shifter boots on transmission and transfer case
- New windshield, new rubber gaskets and seals
- New interior lights
- New tailgate cables

EXTERIOR & ACCESSORIES

- Black double-tube bumper package
- Full Decal Kit (Renegade, Laredo, Etc)

Complete Frame Off Restoration Package	24000.00
Upgrade Dual Exhaust	400.00
20 Gallon Fuel Tank	400.00
Optima Battery	100.00
Serpentine Drive Belt	800.00
Detroit Front Locker	489.00
Upgrade To Wide Axles	2200.00
Kentrol Black Stainless	700.00
Upgrade To 33 Inch	160.00
Add Spare Tire and Wheel	265.00
Xenon Wide Flares	300.00
Tuffy Console Stereo	1170.00
Alum Radiator	325.00
4 inch Pro Comp Upgrade	400.00
Roll Bar Modification	400.00
V8 GM Fuel Injection Upgrade	5000.00
Dual Ext Loaded Front Fenders	220.00
Seat Upholstery modification	400.00
Autometer Gauge Package	600.00
Appraisal Pkg	350.00
Customer Base Jeep (Credit)	-3500.00
Discount Options	-716.45

- Horn
- All screws and bolts in stainless steel powder coated black.
- Everything black (Minors and attachments, antenna and attachment, etc....)
- Engine bay same color as jeep
- No stickers or advertisements
- Heat
- Does soft top cover everything (fully enclosed with doors)?
- Is everything on the engine NEW –(alternator, carburetor, water pump, fuel pump, distributor, new ignition wires, new solenoid, battery, battery cables, engine mounts, radiator, coolant, hoses, belts.)

Add:

- Black carpet
- Rear disc brake system \$ 780.00
- Hood lights
- Hood Latches

Did you forget:

- 8000lb Warn winch with mounting plate / 9500 Winch \$ 900.00 / 1,100.00



Kandy Basecoats: KBC01 - Brandywine

Image 1 of 21

Click on left (prev) or right (next) side of image OR
use left/right arrow keys to scroll through images.



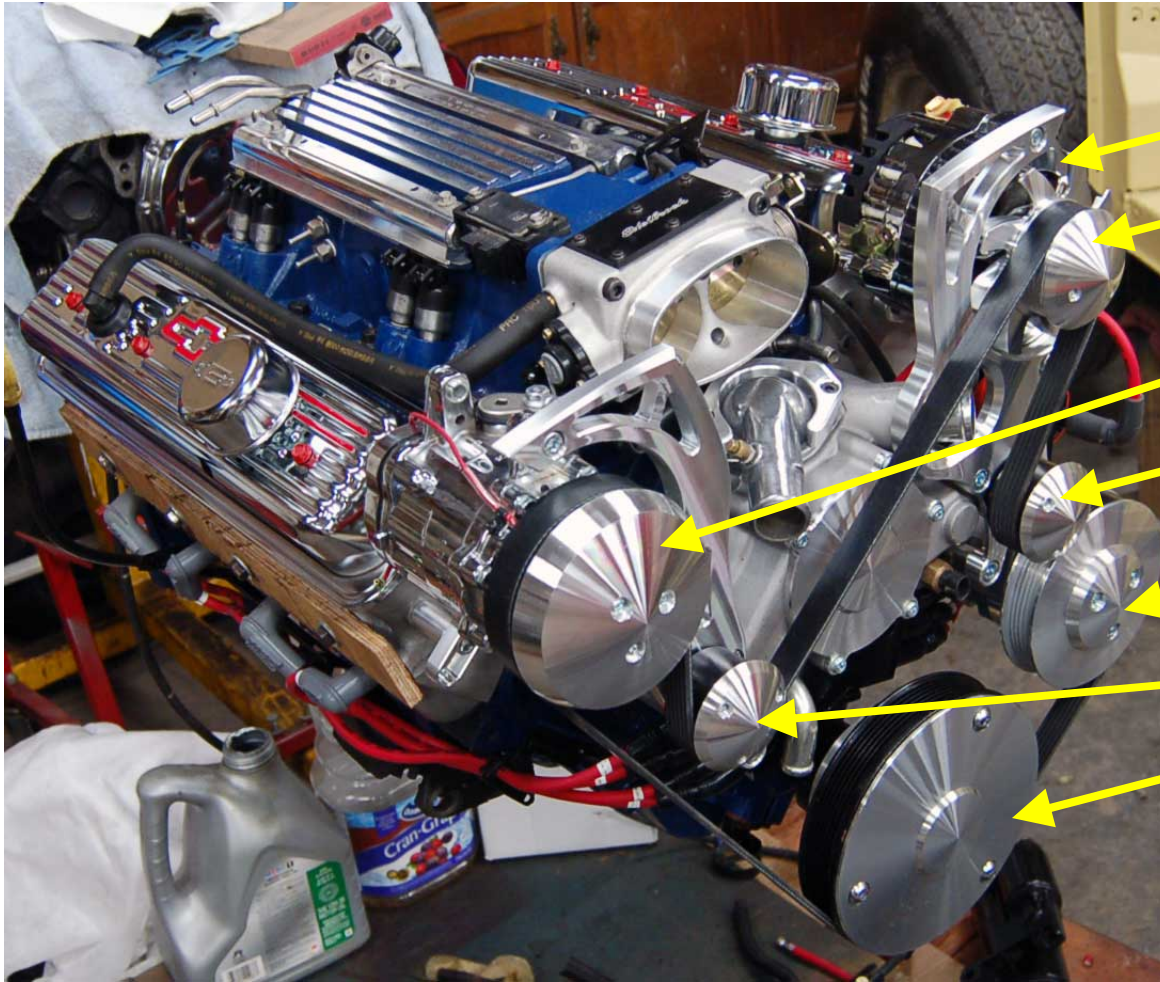

Kentrol Black Stainless Steel Hood Catch TJ-Style Pair

<http://www.jeep4x4center.com/kentrol-black-stainless-steel-hood-catch-tj-style-50563.html>



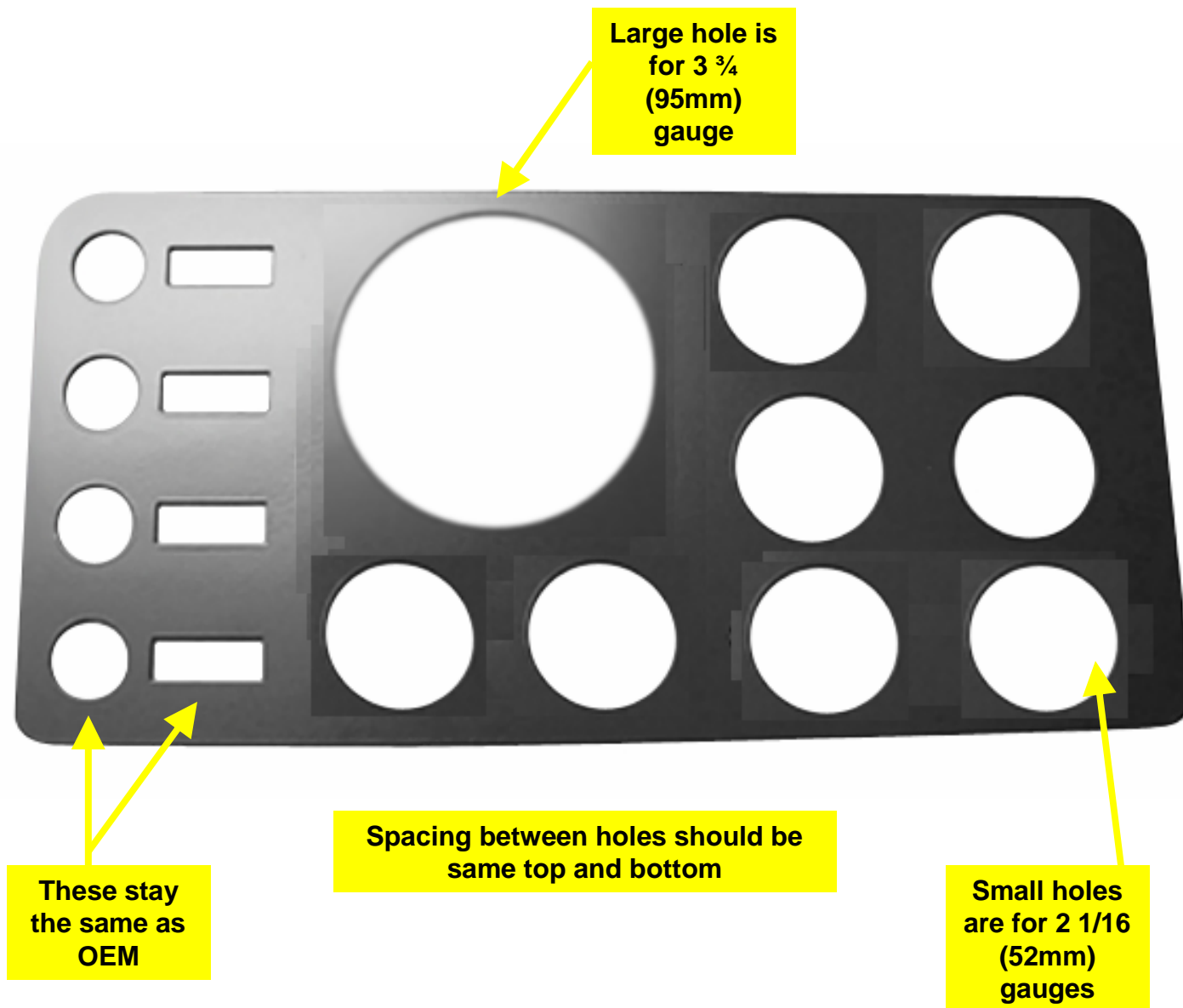



<http://www.glowshiftdirect.com/black-7-color-3-3-4-in-dash-speedometer-gauge.aspx>

<http://www.glowshiftdirect.com/black-7-color-oil-temperature-gauge.aspx>

<http://www.glowshiftdirect.com/black-7-color-water-temperature-gauge.aspx>

<http://www.glowshiftdirect.com/black-7-color-transmission-temperature-gauge.aspx>

<http://www.glowshiftdirect.com/black-7-color-oil-pressure-gauge.aspx>

<http://www.glowshiftdirect.com/black-7-color-tachometer-gauge.aspx>

<http://www.glowshiftdirect.com/Black-7-Color-Clock-Gauge.aspx>

<http://www.glowshiftdirect.com/Black-7-Color-Fuel-Level-Gauge.aspx>

<http://www.glowshiftdirect.com/black-7-color-volt-gauge.aspx>

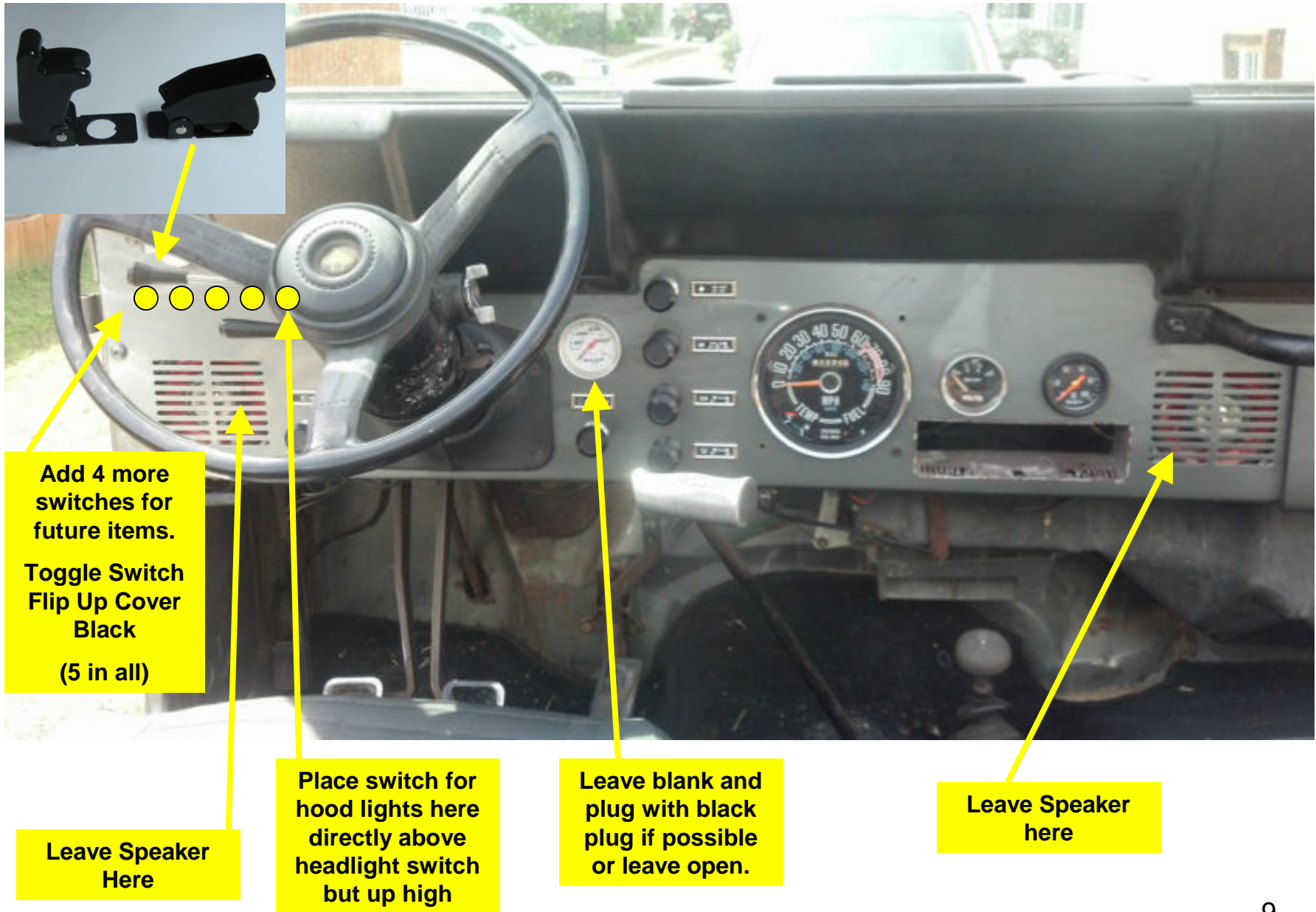

Add 4 more
switches for
future items.
Toggle Switch
Flip Up Cover
Black
(5 in all)

Leave Speaker
Here

Place switch for
hood lights here
directly above
headlight switch
but up high

Leave blank and
plug with black
plug if possible
or leave open.

Leave Speaker
here

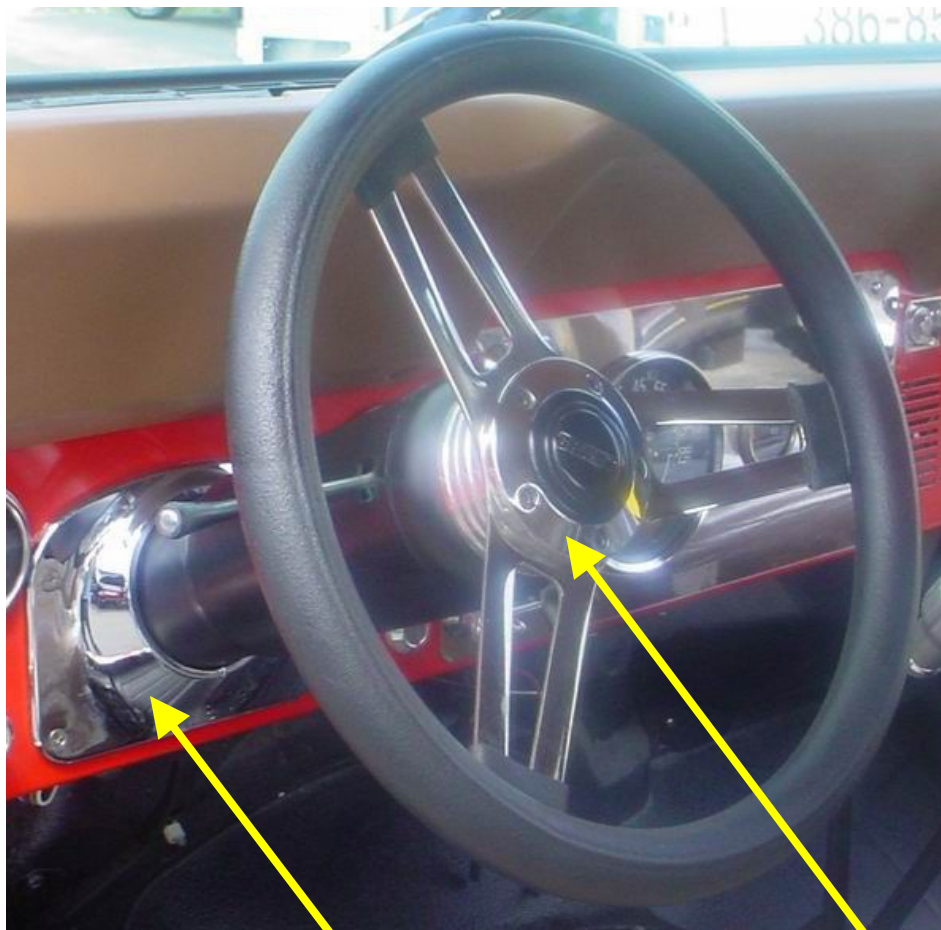

Black

**Anything to do
with steering
column/wheel
should be
black.**

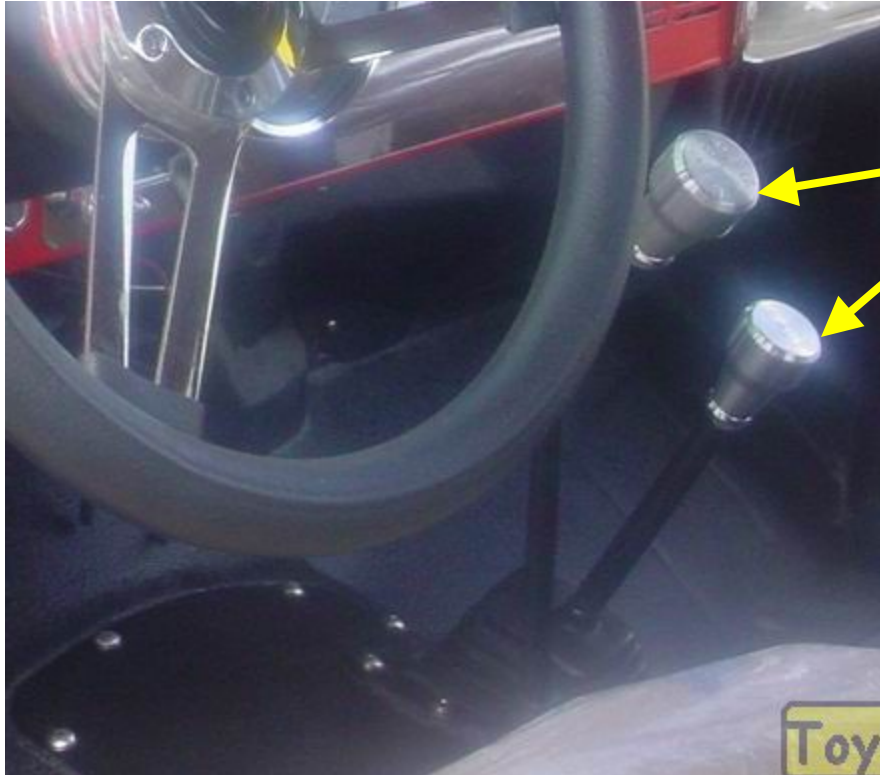

- Gear shift setup like this.
- Black powder coated rods/sticks.
- Knobs should be powder coated to match body.



Black carpet

> [Home](#) > > [Interior](#) > Corbeau 96601, Corbeau Baja XRS Reclining Suspension Seat in Black Vinyl

Corbeau 96601, Corbeau Baja XRS Reclining Suspension Seat in Black Vinyl



(actual products may differ)
[Click to View Larger Image\(s\)](#)

Can stitching be done in body color

Item #:	00517515
Price:	\$349.00
Shipping:	FREE SHIPPING
Qty:	<input type="text" value="1"/>
5th Slot Install?:	<input type="text" value="Please Select"/>
Seat Heater?:	<input type="text" value="Please Select"/>
Inflatable Lumbar?:	<input type="text" value="Please Select"/>
ADD TO CART >>	

[Print This Page](#)

[Add to Wish List](#)

Like Sign Up to see what your friends like

+1 Recommend this on Google

This section
should match
body paint

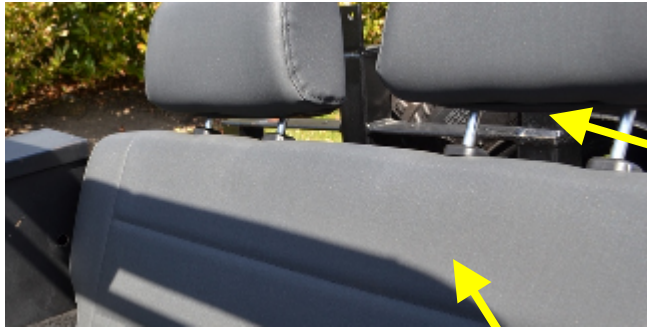

2 Head Rest

**This section
should match
body paint**

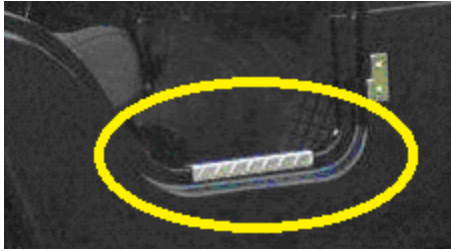

- Step protector should be made with the diamond plate (Black)



- Roll bar built like this and attached to top of windows.
- Powder coated black to match bumpers.
- Then covered in some type cushion.
- Seat belt attached like in 1st photo.



- 1st Choice Full size spare with matching rim.
- American Racing AR23



- 2nd Choice (Five Hole)
- American Racing Gambler
- Centerline Champ 500





- I want double shocks setup like the photo.
- Shocks black with no names on them. (no brand)
- Mickey Thompson – Baja MTZ SLT LT375/55R16 - Blackwall**

Part #	Size	Size Equivalent	Appx. Weight	Load Range	Max Load	Max PSI	Approved Rims	Measuring Rim	Sidewall Width	Tread Width	Overall Diameter	Tread Depth
5267	LT375/55R16	33X15.50R16LT	80	E	3,750	65	10.0-13.0	12.0	15.4	11.8	32.4	23/32



Morris
4x4 Center
Jeep Parts and Accessories

[Login](#) | [Order Status](#) | [Returns](#) | [Wish List](#) | [Contact Us](#)



1-877-553-5337
Call our Jeep Parts Specialists!

[Bumpers](#) | [Fender Flares](#) | [Floor Mats](#) | [Jeep Parts Diagrams](#) | [Seats & Covers](#) | [Soft Tops](#) | [Suspension & Lift Kits](#) | [Tires](#)

***FREE SHIPPING** ON ORDERS OVER \$99

NO PROMO
CODE NEEDED!

***SPECIAL DISCOUNTS** MII

Choose your Jeep

- Wrangler JK 2D/4D 2007-2013 >
- Wrangler TJ 1997-2006 >
- Wrangler TJ Unlimited 2004-2006 >
- Wrangler YJ 1987-1995 >
- Jeep CJ7 1976-1986 >
- Jeep CJ8 Scrambler 1981-1986 >
- Jeep CJ5 1955-1983 >
- Jeep Willys 1941-1955 >
- Jeep Cherokee XJ 1984-2001 >
- Grand Cherokee ZJ 1993-1998 >

[Home](#)

Tire, Baja MTZ 10 Ply SLT Mickey Thompson



Vehicle Fitment

LT375/55R16



Part Number: **MT5267**

Our Price: **\$328.99**

Shipping Surcharge: **+\$19.99**

Customer Reviews: [Be the first to review this product](#)

Quantity:

1



* This product is excluded from all promotions.

[Add To Wishlist](#)

[Delivered in 1-7 Business Days](#)

<http://www.jeep4x4center.com/tire-baja-mtz-10-ply-slt-mickey-thompson-mt5267.html>

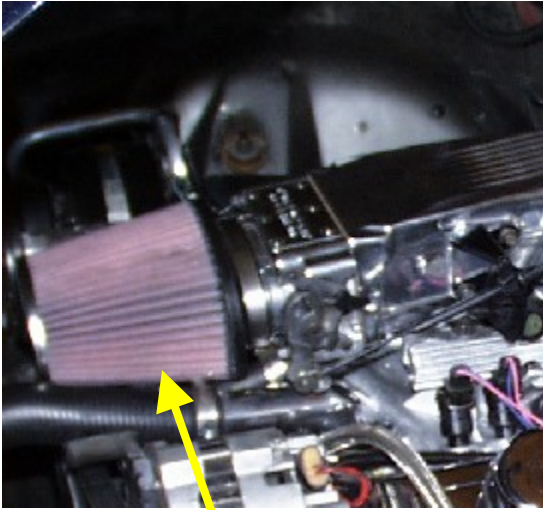

Air filter like this.



- Everything underneath should be black.
- Dual exhaust (one on each side) should be out the back.



- Storage box (one on each side) should be lockable
- Speaker should be installed in the end at an angle.
- Box should be made on diamond plate and powder coated black

- Stereo should be Bluetooth capable.



- Console should be model with cup holders.





- I want winch
- Duel bumper front and back in black.
- Front bumper exactly like photo 3.
- Side tube with the rubber mat. All in black.





- Lights on both sides like this and black.

